





Item list

	Standard Sleeve (Ø3.30-Ø4.30 mm implants)		Narrow MGUIDE Sleeve (Ø3.30-Ø3.90 mm implants)		Fixation Pin Sleeve
Sleeve Type					
Item Number	MG-LS071	MG-LS041	MG-NS070	MG-NS040	MG-FS020
Inner Diameter (mm)	5.5	5.5	4.0	4.0	2.0
Outer Diameter (mm)	7.0	7.0	5.5	5.5	5.0
Height (mm)	7.5	4.5	7.5	4.5	7.0



MG-SI455 | MGUIDE sleeve insertion tool, Ø5.50x4mm



MG-NSI40 | MGUIDE narrow sleeve insertion tool, Ø4x 4mm



MG-FP020 | MGUIDE fixation pin, Ø2mm



MG-US424 | MGUIDE universal sleeve insertion tool, H4mm



Filtek™ Bulk Fill*



MT-MSD20 | Surgical adapter driver

Instructions for use

The sleeve insertion instructions are designed to enable a uniform and accurate insertion process. A controlled insertion process is essential to ensure sleeve stability and overall system accuracy.

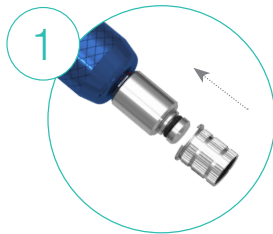

Assemble the sleeve insertion tool to the corresponding surgical adapter driver. For MGUIDE fixation sleeve (MG-FS020) use the fixation pin to hold the sleeve. Place the guide sleeve on the sleeve insertion tool.

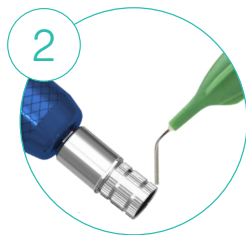

Place a sparing amount of Filtek™ Bulk Fill* on the guide sleeve and spread evenly.

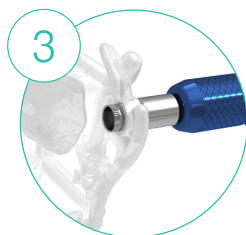

While firmly holding the MGUIDE surgical template, insert the sleeve into the template. Remove any excess Filtek™ Bulk Fill* from, in or around the template.



Cure the template with sleeves in a eyevolution light-curing unit for a minimum of 3 minute. recommended led output intensity should be between 550-2000mW/cm² in the 400-500 nm wavelength range.

Sleeve Insertion

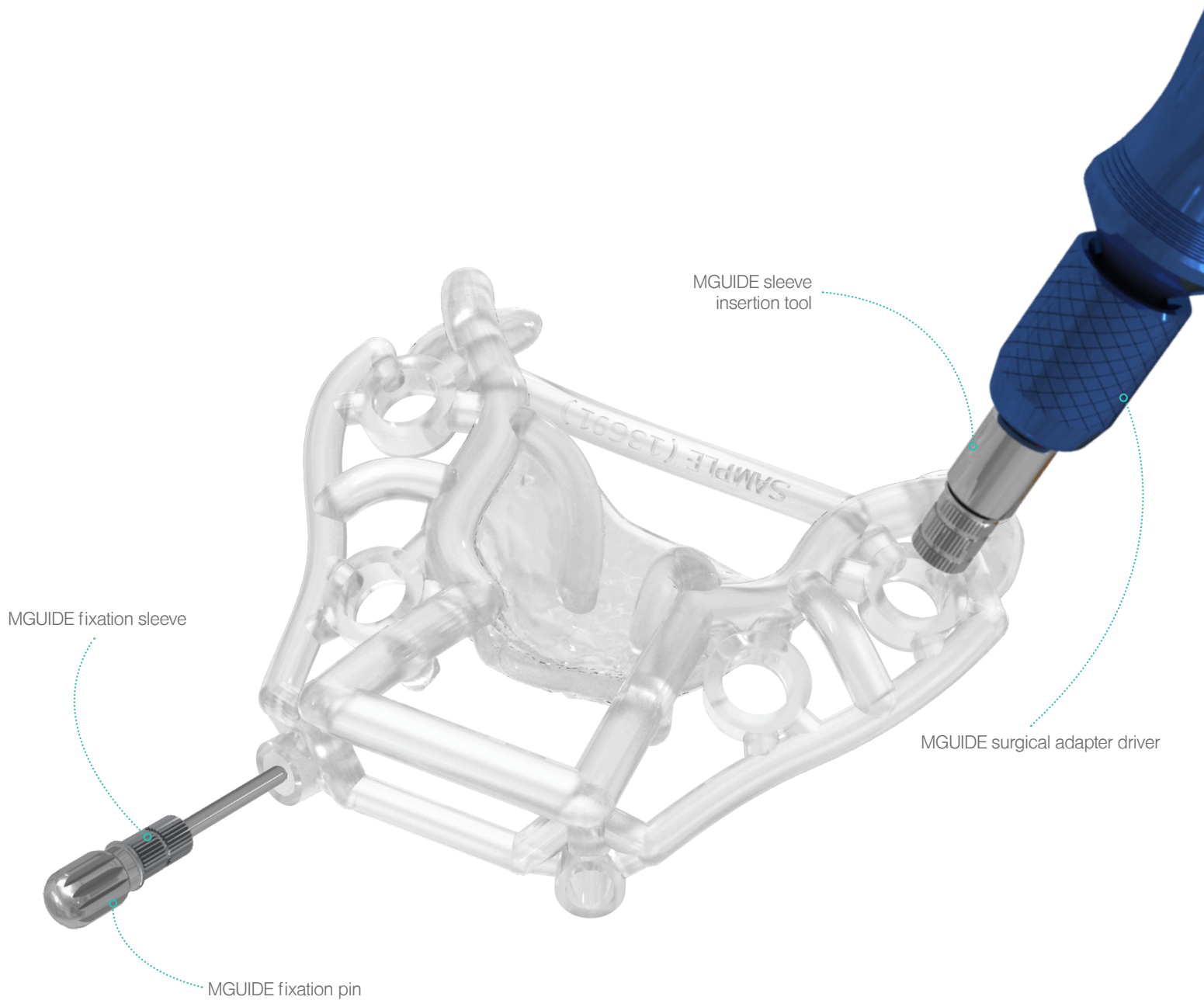

*Filtek™ Bulk Fill is a registered Trade Mark of the 3M Corporation.
To purchase this item, please contact the 3M sales distributor in your region.

Illustrations shown are for demonstration purposes only.